

THIS DRAWING IS AN UNCONTROLLED COPY UNLESS STAMPED OTHERWISE

CONTRACTORS SHALL VERIFY ALL DIMENSIONS BEFORE ANY JOB COMMENCES. ALL SHOP DRAWINGS SHALL BE SUBMITTED TO THE SUPERINTENDENT AND MANUFACTURE SHALL NOT COMMENCE PRIOR TO THE RETURN OF UNMARKED SHOP DRAWINGS SIGNED BY THE CONSULTANT. FIGURED DIMENSIONS SHALL TAKE PRECEDENCE OVER SCALED THIS DRAWING SHOULD BE IN CONFORMANCE WITH ALL RELEVANT CONTRACT SPECIFICATIONS AND DRAWING COPYRIGHT OF THIS DRAWING IS VESTED IN WARDLE

- General Notes
- PERFORATIONS OCCUR IN FOUR SIZES:
 - = DIAMETER OF 10mm
 - = DIAMETER OF 15mm
 - = DIAMETER OF 20mm
 - = DIAMETER OF 25mm
 - ALL DIGITAL ARTWORK FILES WILL BE PROVIDED BY ARCHITECT.
 - CONTRACTORS TO REFER TO RELATED ARCHITECTURAL SPECIFICATION SECTIONS FOR 3D MODEL INTEGRATION REQUIREMENTS.
 - NO VENEER AT EDGE UNLESS OTHERWISE NOTED

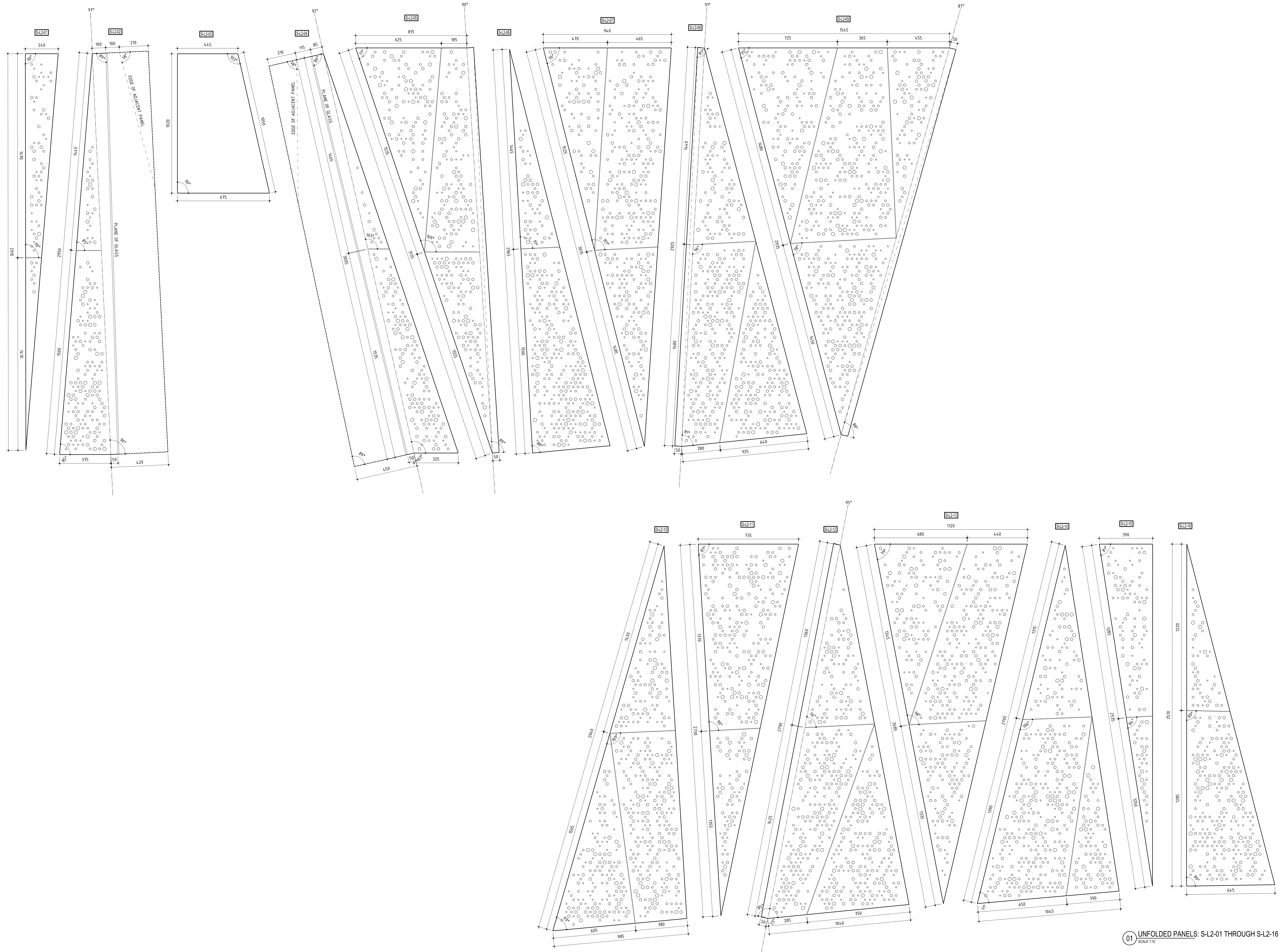

SOUTH FACE: S-L2-01 THROUGH S-L2-16

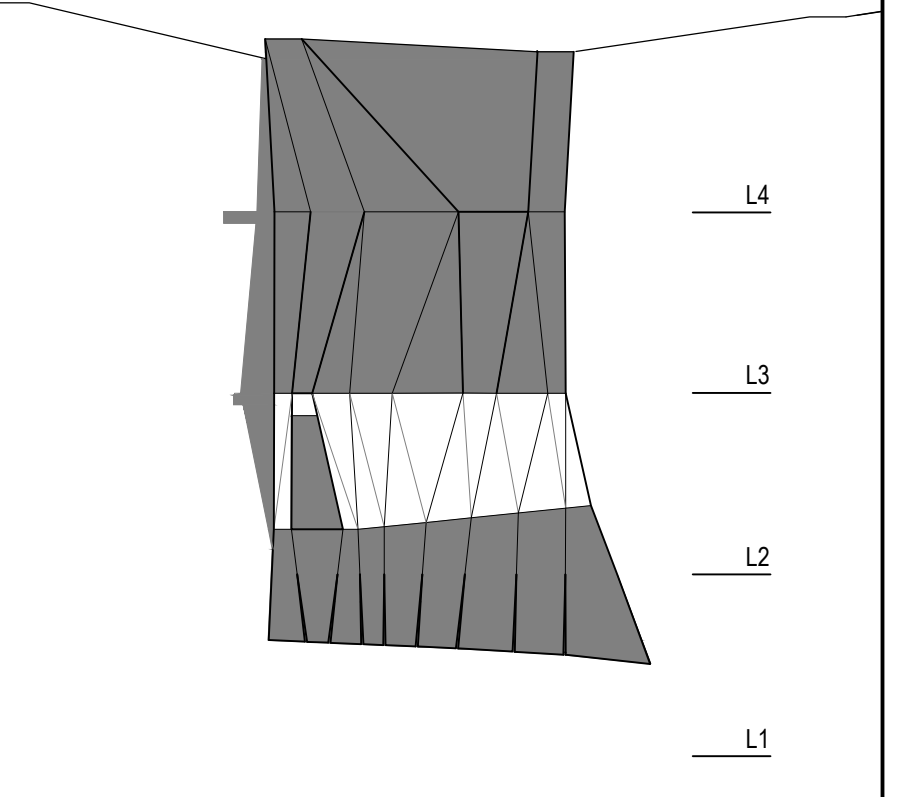

Rev	Issue	Revision Description	Amd	Date
A	SG	CONSTRUCTION ISSUE	-	06.01.14
D4	JC	100% CD - TENDER ISSUE	-	07.09.12
03	JC	90% CD ISSUE	-	10.06.12
02	JC	75% CD ISSUE	-	13.07.12
01	JC	50% CD ISSUE	-	01.06.12

Rev	Issue	Revision Description	Amd	Date

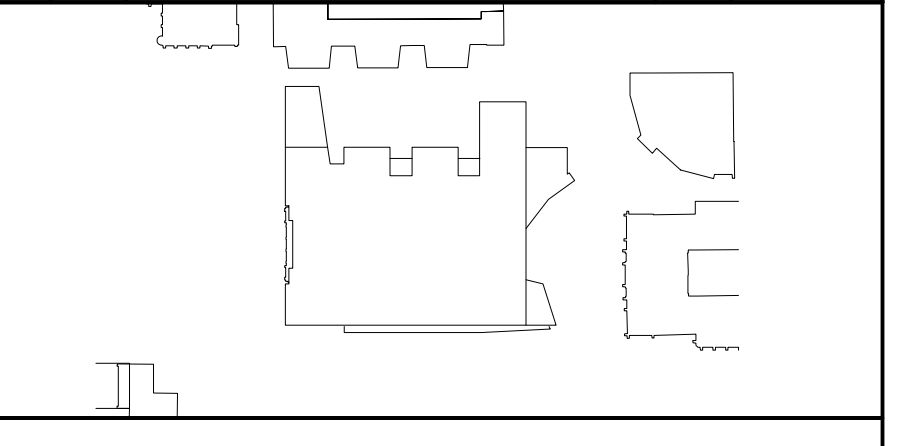

NADAAA
 NADAAA
 1520 Washington Street No. 2
 Boston, Massachusetts
 02118 USA
 Telephone: +1 617 442 6332
 Facsimile: +1 688 442 1417
 Email: nada@nadaaa.com
 nada@nadaaa.com

John Wardle Architects
 © 2011 John Wardle Architects
 Level 10, 180 Russell Street, Melbourne Victoria 3000 Australia
 Tel : +613 9654 8700 www.johnwardlearchitects.com

Client: **University of Melbourne Parkville Campus**

Project: **Faculty of Architecture Building and Planning**

Title: **HANGING STUDIO UNFOLDED PANELS**

Project No.	0913	Scale	1:10 @ A0 1:20 @ A2
Drawing No.	AR5135	Revision	A
Date	JAN 2014	Dwn	-
Drawn	-	Co-Ord	-
Check	-	FILENAME	-###

FOR CONSTRUCTION

UNFOLDED PANELS: S-L2-01 THROUGH S-L2-16
 SCALE: 1:10